

**Code: 610 050 03**  
**6 PISTON PUMPS 50 LT.**  
**TYP 610**

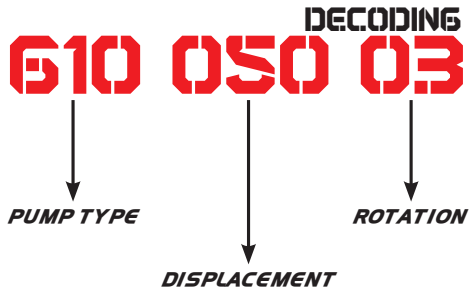

PISTON PUMPS

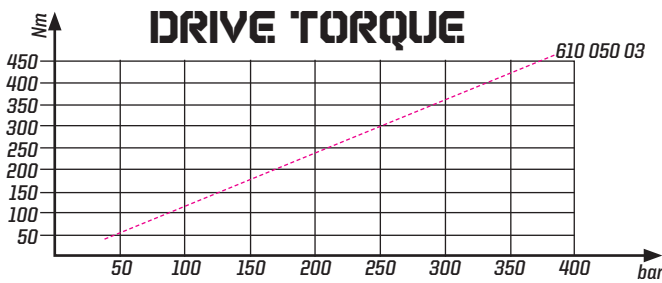
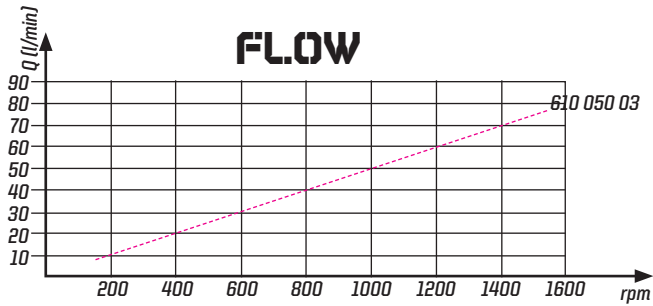

Fluid Temp. °C	Input Pres. Bar	Optimale K. Viscosity	Oil Filtering
0 / 90	0,3 / 2 bar	10 / 100 cST	> 200 bar : 25 um < 200 bar : 35 um



**BIDIRECTIONAL PUMP**

**USED PLACED :**  
DUMPER TRUCKS  
PRIVATE AIM WINCHES  
TRACTOR LADLES

**NOTE :** THE ABOVE SPECIFICATIONS REFER TO OIL TYPE ISO VG 46 AT 50°

**NOTE :** TAKE A CONSIDERATION THAT OIL INLET TUBE CONNECTOR MUST BE VERTICAL POSSITION & THE PUMP MUST BE 100 mm DISTANCE TO THE OIL TANK DURING TO ASSEMBLY. BEFORE STARTING THE PUMP BLEED THE AIR.

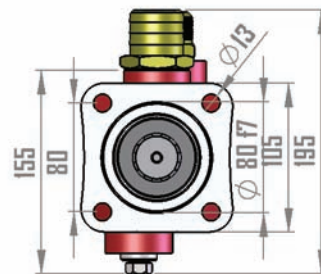
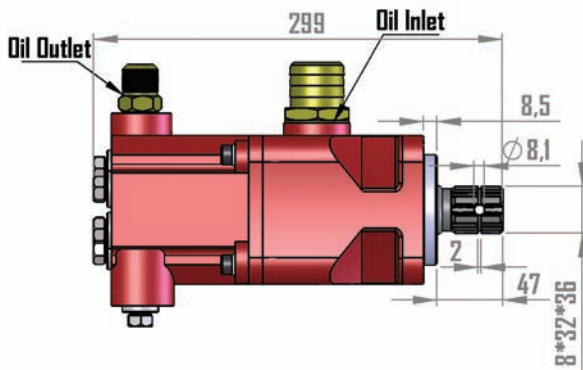





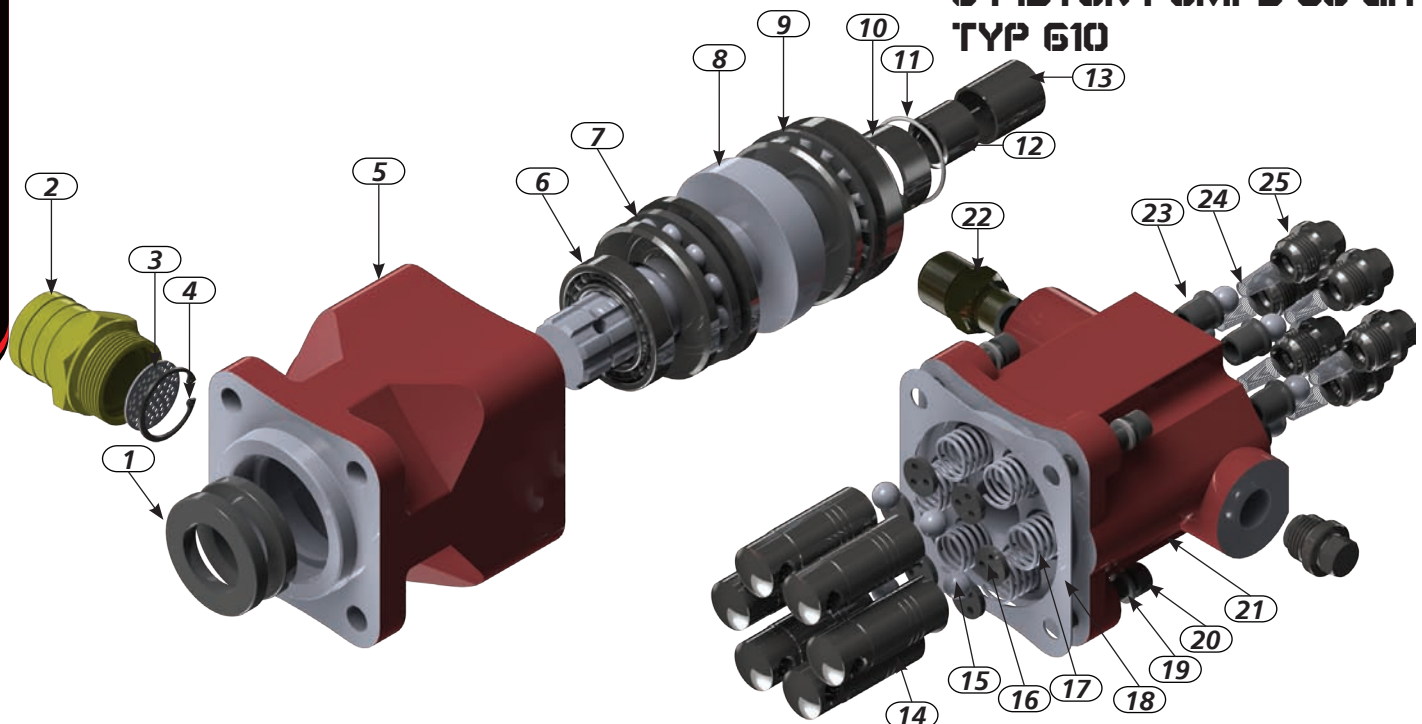

Code	Displacement cm³/1000	Rotation	Test Pressure 1	Test Pressure 2	Max. Test Pressure	Oil Inlet	Oil Outlet	Max. Con. Speed Rpm	Max. Inter. Speed Rpm	Weight
610 050 03	49,5	Double	270	290	310	6 1" 1/4"	M22 1,5"	1700	1900	14,3

Test Pressure 1 : 60 sec.      Test Pressure 2 : 15 sec. Max.      Max Test Pressure : 5 sec. Max.

**Code: 610 050 03**  
**6 PISTON PUMPS 50 LT.**  
**TYP 610**



<p>Pos: 1 Qty: 2</p>  <p>Code: 020 040 402 Seal Mim 35*58*8</p>	<p>Pos: 2 Qty: 1</p>  <p>Code: 020 110 007 Nipple 1" 1/4</p>	<p>Pos: 3 Qty: 1</p>  <p>Code: 020 090 027 Filter 1*1</p>	<p>Pos: 4 Qty: 1</p>  <p>Code: 020 010 235 Circlip 472/35</p>	<p>Pos: 5 Qty: 1</p>  <p>Code: 020 080 045 Cover</p>	<p>Pos: 6 Qty: 1</p>  <p>Code: 020 020 801 Bearing 6007</p>	<p>Pos: 7 Qty: 1</p>  <p>Code: 020 020 605 Bearing 51308</p>
<p>Pos: 8 Qty: 1</p>  <p>Code: 020 080 046 Crank Shaft</p>	<p>Pos: 9 Qty: 1</p>  <p>Code: 020 020 902 Bearing 960508 oc</p>	<p>Pos: 10 Qty: 1</p>  <p>Code: 020 060 109 Bush 35*40*17</p>	<p>Pos: 11 Qty: 1</p>  <p>Code: 020 005 009 Circlip 35</p>	<p>Pos: 12 Qty: 1</p>  <p>Code: 020 060 110 Bush 20*25*20</p>	<p>Pos: 13 Qty: 1</p>  <p>Code: 020 060 108 Bush 25*28*30</p>	<p>Pos: 14 Qty: 9</p>  <p>Code: 020 090 061 Piston</p>
<p>Pos: 15 Qty: 18</p>  <p>Code: 020 020 101 Ball 1/2"</p>	<p>Pos: 16 Qty: 9</p>  <p>Code: 020 090 018 Washer 3*1</p>	<p>Pos: 17 Qty: 9</p>  <p>Code: 020 005 006 Spring</p>	<p>Pos: 18 Qty: 1</p>  <p>Code: 020 050 106 Seal</p>	<p>Pos: 19 Qty: 4</p>  <p>Code: 020 100 039 Washer M 12</p>	<p>Pos: 20 Qty: 4</p>  <p>Code: 020 100 041 Screw M 12*40</p>	<p>Pos: 21 Qty: 1</p>  <p>Code: 020 080 047 Body</p>
<p>Pos: 22 Qty: 1</p>  <p>Code: 020 110 009 Nipple M22*1,5 1" 1/6</p>	<p>Pos: 23 Qty: 9</p>  <p>Code: 020 090 062 Ring</p>	<p>Pos: 24 Qty: 9</p>  <p>Code: 020 005 004 Spring</p>	<p>Pos: 25 Qty: 9</p>  <p>Code: 020 090 063 Plug M 22*1,5</p>			

www.steelform.com